

SURVEYOR'S OFFICE

Hamilton County

Kenton C. Ward, CFM
Surveyor of Hamilton County
Phone (317) 776-8495
Fax (317) 776-9628

Suite 188
One Hamilton County Square
Noblesville, Indiana 46060-2230

January 11, 2007

TO: Hamilton County Drainage Board

RE: S.M. Smith Drain, 169th Street Relocation Arm

Attached is a petition filed by Platinum Properties, LLC along with plans, calculations, quantity summary and assessment roll for the 169th Street Relocation Arm, S.M. Smith Drain to be located in Washington Township. I have reviewed the submittals and petition and have found each to be in proper form.

I have made a personal inspection of the land described in the petition. Upon doing so, I believe that the drain is practicable, will improve the public health, benefit a public highway, and be of public utility and that the costs, damages and expenses of the proposed drain will probably be less than the benefits accruing to the owners of land likely to be benefited. The drain will consist of the following:

12" RCP	390 ft.	27" RCP	218 ft.
15" RCP	144 ft.	36" RCP	2,186 ft.
18" RCP	109 ft.	42" RCP	111 ft.

The total length of the drain will be 3,158 feet.

The new arm is shown on the 169th Street Reconstruction Plans by Stoepelwerth & Associates, Inc., job number 34676STR, dated March 16, 2005. The new arm is shown on sheet numbers C400, C401, C402, and C403. It shall consist of the lengths between the following Structures:

Str. 564, 574, 577, 578, 579, and 580
Str. 549C, 549B, and 549A
Str. 497A, 497, 491, 560, 489, 593A, 593, 594A, 594, and 595
Str. 607 to 608
Str. 598, 599, and 600
Str. 601, 602, and 603
Str. 597, 596, and 594
Str. 591, 592, and 593
Str. 562, 561, and 560

The arm will remove 8.43 acres of 169th Street right of way from the assessment roll of the John Edwards Drain. This same 8.43 acres of 169th Street right of way will be added to the S.M. Smith assessment roll. This will result in an increase of \$84.30 to the S.M. Smith assessment roll and a decrease of \$84.30 to the John Edwards assessment roll.

The cost of the drain construction is to be paid by Platinum Properties, LLC.

The petitioner has submitted surety for the proposed drain at this time. The sureties which are in the form of a Performance Bond are as follows:

Agent: Bond Safeguard Insurance Company
Date: August 17, 2005
Number: 5018391
For: Storm Sewer and Erosion Control
Amount: \$360,444.000

Parcels assessed for this drain may be assessed for the Little Eagle Creek Drain at sometime in the future.

I believe this proposed drain meets the requirements for Urban Drain Classification as set out in IC 36-9-27-67 to 69. Therefore, this drain shall be designated as an Urban Drain.

The easement for part of this drain from Str. 602 to 603, Str. 599 to 600, Str. 608 easterly 80 feet, and Str. 595 to 594 shall be per the drainage easement granted to the Board of Commissioners of Hamilton County on parcel 08-09-03-00-00-023.002, owned by the Town of Westfield, recorded as instrument number 200500024300 in the Office of the Hamilton County Recorder. On the remained of parcel 08-09-03-00-00-023.002, owned by the Town of Westfield, the easement shall be 50 feet from the centerline of the drain on the west and south side of the drain from Str. 594 to upstream of Str. 593A. The easement from Str. 549B to Str. 549C shall be 50 feet from the centerline of the drain on the east side and will be in future common area of a future section of Maple Knoll. The easement from Str. 578 to Str. 579 shall be 15 feet from the centerline of the drain on the east side and will place new easement on parcel 08-09-03-00-00-014.000, owned by Roman Catholic Diocese Church. All other easement shall be 75 feet from the centerline of the drain. The drain that falls in area of future development of Maple Knoll will be reduced by subdivision non-enforcement agreements at the time those sections are platted. This includes parcels 08-090-03-00-00-023.000, 08-09-03-00-00-013.000, 08-09-03-00-00-020.000, and 08-09-03-00-02-112.000 all owned by Platinum Properties.

I recommend the Board set a hearing for this proposed drain for February 26, 2007.

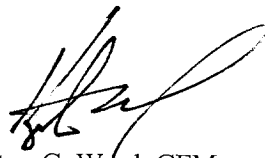

Kenton C. Ward, CFM
Hamilton County Surveyor

KCW/pll

The Petitioner further requests that the Drain be classified as an Urban Drain as per IC 36-9-27-69(d).

RECORDED OWNER(S) OF LAND INVOLVED

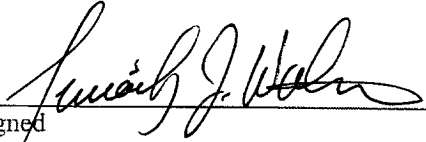
Signed _____

Timothy J. Walter
Printed Name _____

March 16, 2005
Date _____

Signed

Printed Name

Date

Signed

Printed Name

Date

Signed

Printed Name

Date

FINDINGS AND ORDER

CONCERNING THE MAINTENANCE OF THE

John Edwards Drain, 169th Street Relocation

On this **26th day of February 2007**, the Hamilton County Drainage Board has held a hearing on the Maintenance Report and Schedule of Assessments of the **John Edwards Drain, 169th Street Relocation**.

Evidence has been heard. Objections were presented and considered. The Board then adopted the original/amended Schedule of Assessments. The Board now finds that the annual maintenance assessment will be less than the benefits to the landowners and issues this order declaring that this Maintenance Fund be established.

HAMILTON COUNTY DRAINAGE BOARD

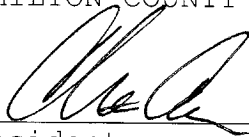

President

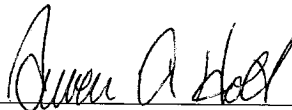

Member

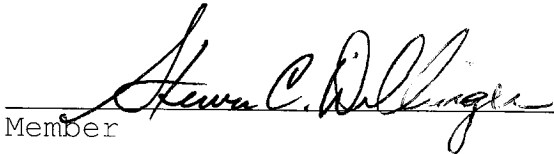

Member

Attest:



FINDINGS AND ORDER

CONCERNING THE MAINTENANCE OF THE

S. M. Smith Drain, 169th Street Relocation

On this **26th day of February 2007**, the Hamilton County Drainage Board has held a hearing on the Maintenance Report and Schedule of Assessments of the **S. M. Smith Drain, 169th Street Relocation**.

Evidence has been heard. Objections were presented and considered. The Board then adopted the original/amended Schedule of Assessments. The Board now finds that the annual maintenance assessment will be less than the benefits to the landowners and issues this order declaring that this Maintenance Fund be established.

HAMILTON COUNTY DRAINAGE BOARD



President

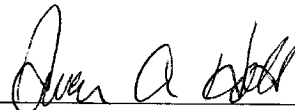

Member

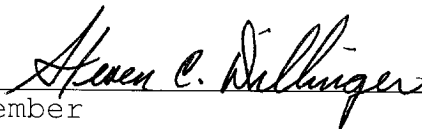

Member

Attest: 

STATE OF INDIANA)
) ss:
COUNTY OF HAMILTON)

BEFORE THE HAMILTON COUNTY
DRAINAGE BOARD
NOBLESVILLE, INDIANA

IN THE MATTER OF THE
RECONSTRUCTION OF THE
S. M. Smith Drain, 169th Street Relocation

FINDINGS AND ORDER FOR RECONSTRUCTION

The matter of the proposed Reconstruction of the *S. M. Smith Drain, 169th Street Relocation* came before the Hamilton County Drainage Board for hearing on *February 26, 2007*, on the Reconstruction Report consisting of the report and the Schedule of Damages and Assessments. The Board also received and considered the written objection of an owner of certain lands affected by the proposed Reconstruction, said owner being:

Evidence was heard on the Reconstruction Report and on the aforementioned objections.

The Board, having considered the evidence and objections, and, upon motion duly made, seconded and unanimously carried, did find and determine that the costs, damages and expenses of the proposed Reconstruction will be less than the benefits accruing to the owners of all land benefited by the Reconstruction.

The Board having considered the evidence and objections, upon motion duly made, seconded and unanimously carried, did adopt the Schedule of Assessments as proposed, subject to amendment after inspection of the subject drain as it relates to the lands of any owners which may have been erroneously included or omitted from the Schedule of Assessments.

The Board further finds that it has jurisdiction of these proceedings and that all required notices have been duly given or published as required by law.

Wherefore, it is ORDERED, that the proposed Reconstruction of the *S. M. Smith Drain, 169th Street Relocation* be and is hereby declared established.

Thereafter, the Board made inspection for the purpose of determining whether or not the lands of any owners had been erroneously included or excluded from the Schedule of Assessments. The Board finds on the basis of the reports and findings at this hearing as follows:

HAMILTON COUNTY DRAINAGE BOARD



PRESIDENT



Member



Member

ATTEST:

Executive Secretary

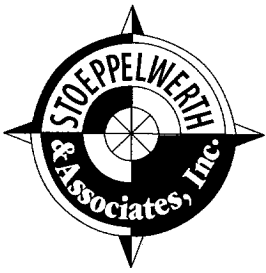

CONSULTING ENGINEERS • LAND SURVEYORS

David J. Stoepelwerth, P.E., P.L.S.
President, C.E.O.

Curtis C. Huff, P.L.S.
Vice-President, C.O.O.

R.M. Stoepelwerth, P.E., P.L.S.
President Emeritus

CERTIFICATE OF COMPLETION AND COMPLIANCE

To: Hamilton County Surveyor

Re: 169th Street Reconstruction

I hereby certify that:

1. I am a Registered Land Surveyor or Engineer in the State of Indiana.
2. I am familiar with the plans and specifications for the above referenced subdivision.
3. I have personally observed and supervised the completion of the drainage facilities for the
4. The drainage facilities within the above referenced subdivision to the best of my knowledge, information and belief have been installed and completed in conformity with all plans and specifications.

Signature: Jeffery W. Darling Date: July 28, 2006

Type or Print Name: Jeffery W. Darling

Business Address: Stoepelwerth & Associates, Inc.

9940 Allisonville Road, Fishers, Indiana 46038

Telephone Number: (317) 849-5935

SEAL

INDIANA REGISTRATION NUMBER

900017





SURVEYOR'S OFFICE

Hamilton County

Kenton C. Ward, CFM
 Surveyor of Hamilton County
 Phone (317) 776-8495

Suite 188
 One Hamilton County Square
 Noblesville, Indiana 46060-2230
April 8, 2008

To: Hamilton County Drainage Board

Re: Little Eagle Drain: 169th St Relocation of the SM Smith

Attached are as-builts, certificate of completion & compliance, and other information for 169th Street Relocation of the SM Smith Drain. An inspection of the drainage facilities for this section has been made and the facilities were found to be complete and acceptable.

During construction, changes were made to the drain, which will alter the plans submitted with my report for this drain-dated January 11, 2007. The report was approved by the Board at the hearing held February 26, 2007. (See Drainage Board Minutes Book 10, Pages 87-90) The changes are as follows:

Structure:	Length:	Size	Material:	Up Invert:	Dn Invert	Grade:	Changes(ft):
601-602	36	12	RCP	913.39	913.09	0.83	
602-603	99	15	RCP	913.39	913.09	0.39	-9
598-599	36	12	RCP	914.26	913.96	0.83	
599-600	103	18	RCP	913.96	912.93	1	-6
607-608	277	36	RCP	914.87	912.85	0.73	-28
597-596	32	12	RCP	913.39	913.3	0.28	
596-594	33	12	RCP	913.3	913.11	0.58	3
497A-497	272	36	RCP	916.01	915.61	0.15	1
497-491	50	36	RCP	915.61	915.54	0.14	
491-560	256	36	RCP	915.54	914.97	0.22	2
560-489	197	36	RCP	914.97	914.69	0.14	-3
489-593A	246	36	RCP	914.69	914.34	0.14	5
593A-593	252	36	RCP	914.34	913.92	0.17	-3
593-594A	235	36	RCP	913.92	913.6	0.14	-2
594A-594	237	36	RCP	913.6	913.11	0.21	2
594-595	124	36	RCP	913.11	912.92	0.15	-14
562-561	45	12	RCP	915.44	915.26	0.4	
561-560	26	12	RCP	915.26	914.97	1.11	
591-592	32	12	RCP	916.96	916.54	1.31	
592-593	37	15	RCP	916.54	916.03	1.38	1
549A-549B	35	42	RCP	916.45	916.35	0.29	
549B-549C	73	42	RCP	916.35	916	0.48	-3

580-579	32	12	RCP	921.34	921.01	1.03	
579-578	116	12	RCP	921.01	919.75	1.09	-4
578-577	118	27	RCP	919.75	919.32	0.36	-2
577-574	36	27	RCP	919.32	919.12	0.55	
574-564	58	27	RCP	919.12	918.82	0.52	-4

RCP Pipe Totals:

12	388
15	136
18	103
27	212
36	2146
42	108

Total: 3093

The length of the drain due to the changes described above is now **3093 feet**.

A non-enforcement was needed at this time as an easement was granted by the Town of Westfield and was recorded under instrument #200500024300.

The following sureties were guaranteed by Bond Safeguard Insurance Company and released by the Board on its May 29, 2007 meeting.

Bond-LC No: 5018391

Insured For: Storm Sewers, Erosion Control

Amount: \$360,444.00

Issue Date: August 17, 2005

I recommend the Board approve the drain's construction as complete and acceptable.

Sincerely,

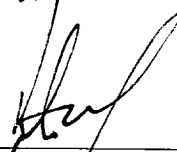

Kenton C. Ward, CFM
Hamilton County Surveyor

KCW/slm

169TH STREET RECONSTRUCTION

Developed by:
 PLATINUM PROPERTIES, L.L.C.
 9551 DELEGATES ROW
 INDIANAPOLIS, IN. 46240
 PHONE: (317) 818-2900
 FAX: (317) 818-2910
 CONTACT PERSON: TIM WALTER

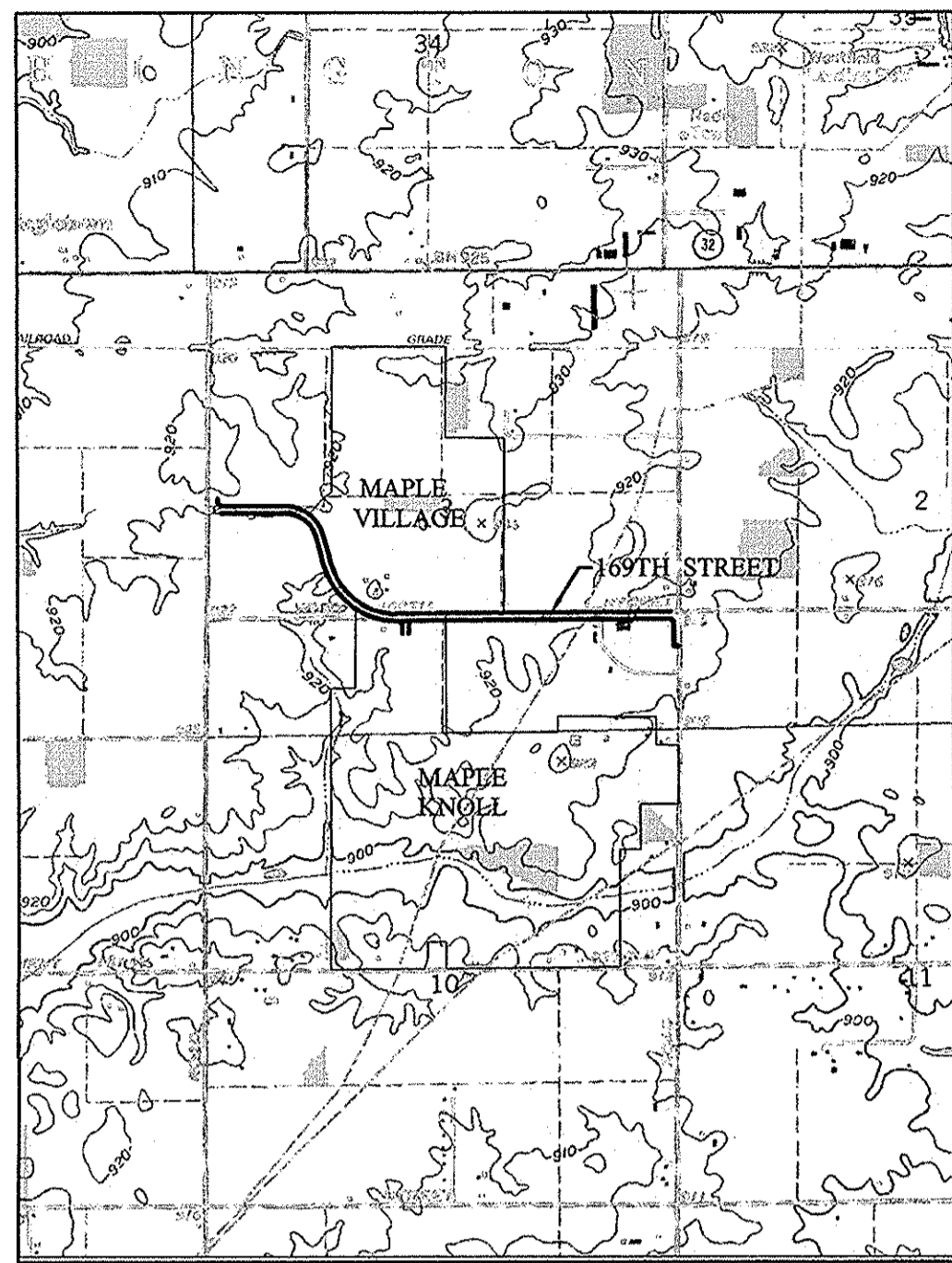

LOCATION MAP

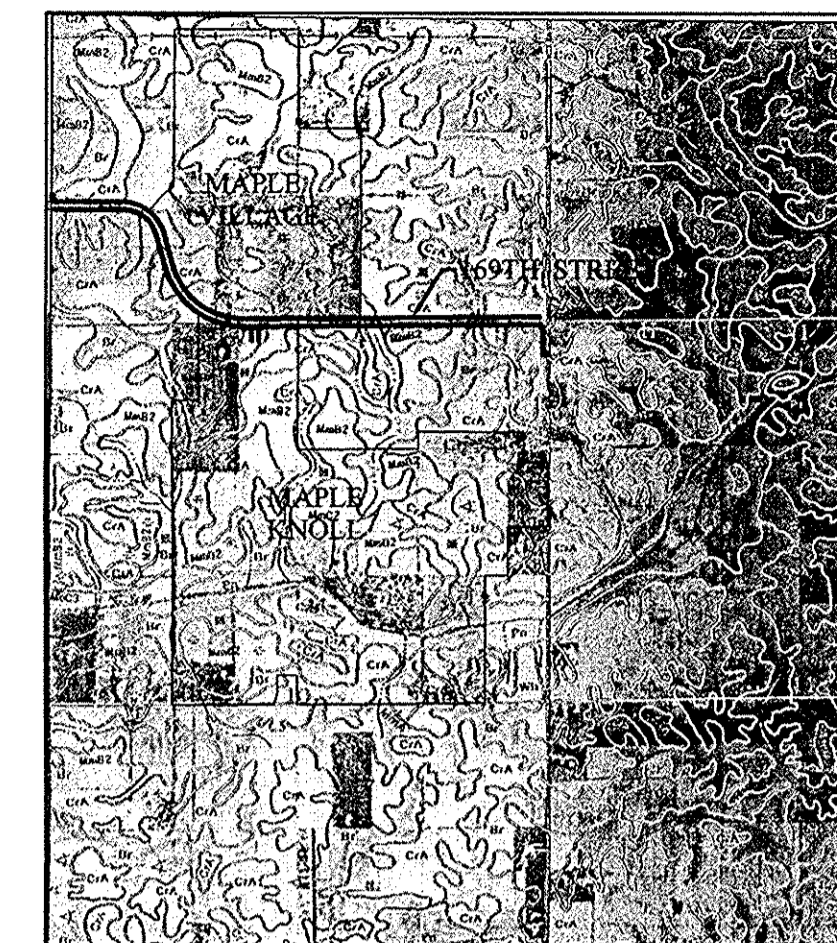

SOILS MAP

Br BROOKSTON
 CrA CROSBY
 MmB2 MIAMI (2 TO 6% SLOPE)
 Pn PATTON

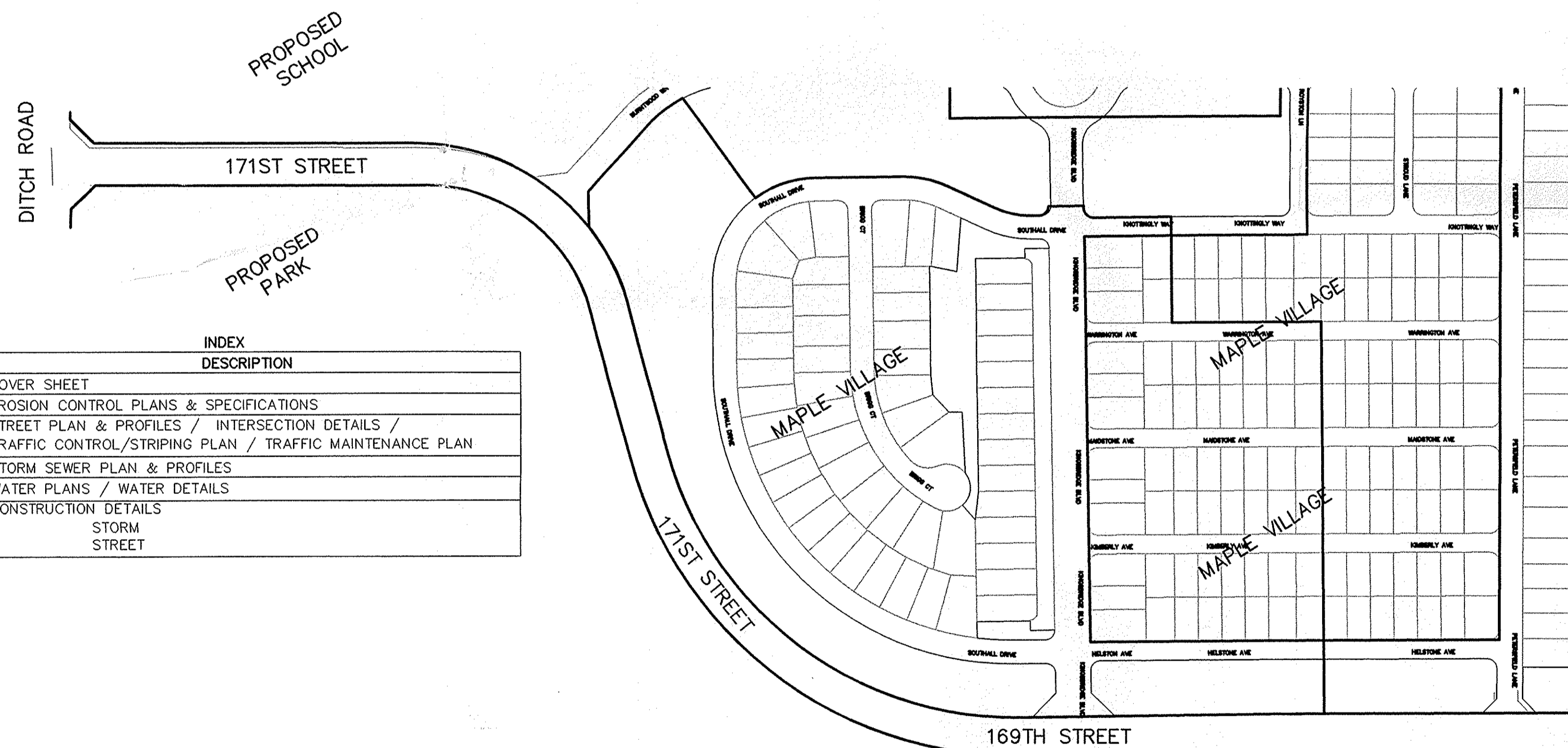

RECORD DRAWING

Jeffery W. Darling 7/27/06
 JEFFERY W. DARLING DATE
 Registered Land Surveyor
 No. 900017

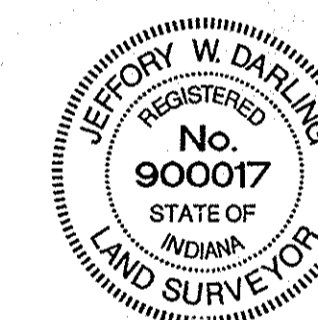

ST. MARIA GORRETTI
 CATHOLIC CHURCH

SPEED LIMIT: 30 M.P.H.



SCALE: 1"=200'

SHT.	INDEX	DESCRIPTION
C001		COVER SHEET
C300-C302		EROSION CONTROL PLANS & SPECIFICATIONS
C400-C411		STREET PLAN & PROFILES / INTERSECTION DETAILS / TRAFFIC CONTROL/STRIPING PLAN / TRAFFIC MAINTENANCE PLAN
C600-C602		STORM SEWER PLAN & PROFILES
C700-C701		WATER PLANS / WATER DETAILS
C800-C801		CONSTRUCTION DETAILS STORM STREET

SHT.	REVISIONS	DESCRIPTION
ALL		REVISED PER DEVELOPER 2/28/05 JDH
ALL		REVISED PER SURVEYOR 4/11/05 JDH
ALL		REVISED PER SURVEYOR 6/2/05 JDH
ALL		REVISED PER WPW COMMENTS 7/1/05 BAH
ALL		REVISED PER DEVELOPER COMMENTS 7/12/05 BAH
ALL		REVISED PER DEVELOPER COMMENTS 7/25/05 BAH

PRINTED
 JUL 28 2006

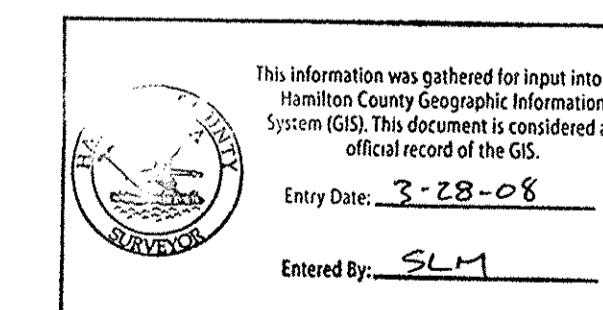

PLANS PREPARED BY:
 STOEPPELWERTH & ASSOCIATES, INC.
 CONSULTING ENGINEERS & LAND SURVEYORS
 9940 ALLISONVILLE ROAD
 FISHERS, INDIANA 46038
 PHONE: (317)-849-5935
 FAX: (317)-849-5942
 CONTACT PERSON: EDWARD E. FLEMING

PLANS CERTIFIED BY:
David J. Stoepfelwerth 03/16/05
 DAVID J. STOEPPELWERTH DATE
 PROFESSIONAL ENGINEER
 NO. 19358



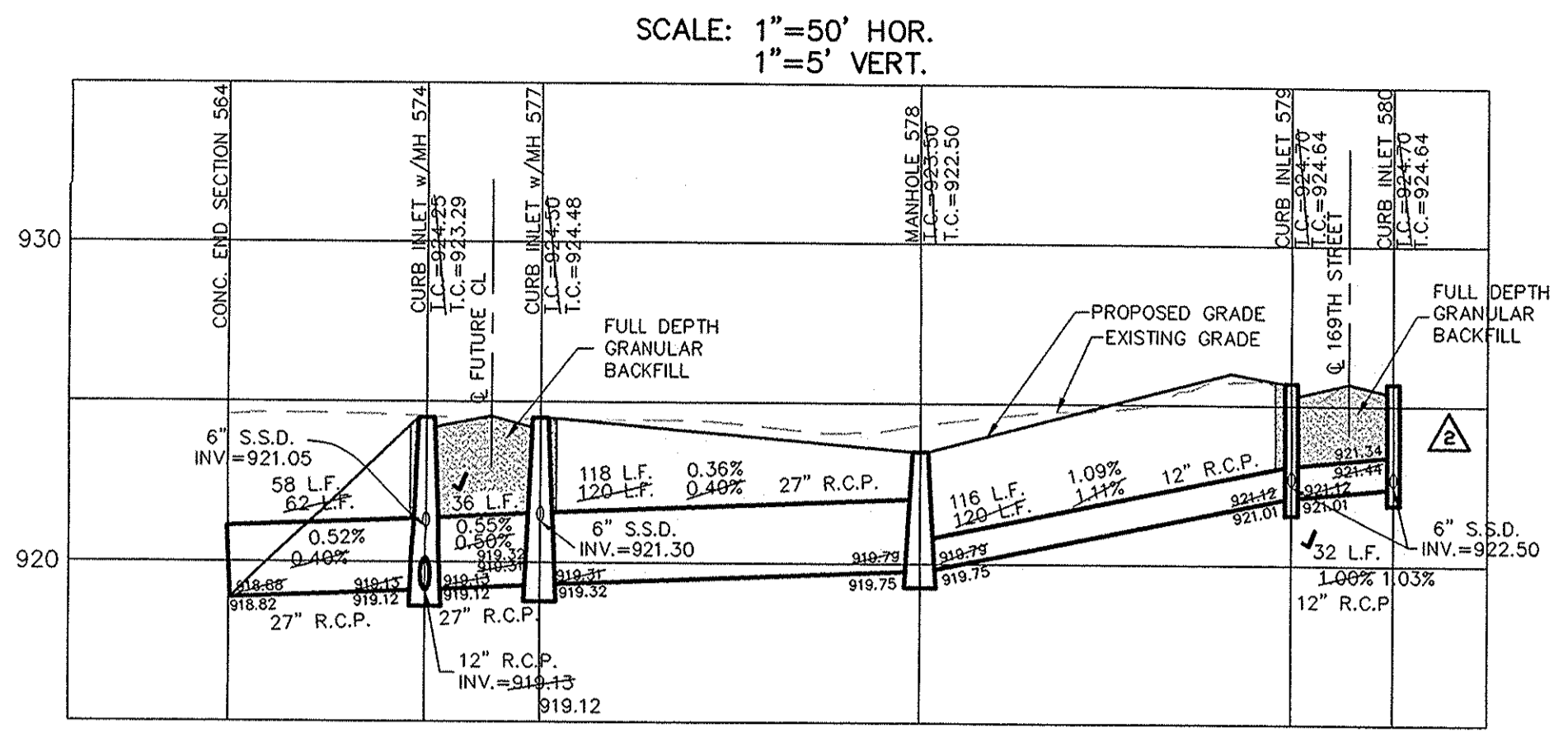

NOTES: 1. DECORATIVE SIGNS, SPRINKLER SYSTEMS, TREES, LANDSCAPING MOUNDS, LIGHT POLES, OR OTHER SUCH AMENITIES ARE NOT PERMITTED IN THE RIGHT OF WAY.
2. ALL CURB IS 6" CHAIR BACK CURB, UNLESS OTHERWISE NOTED.

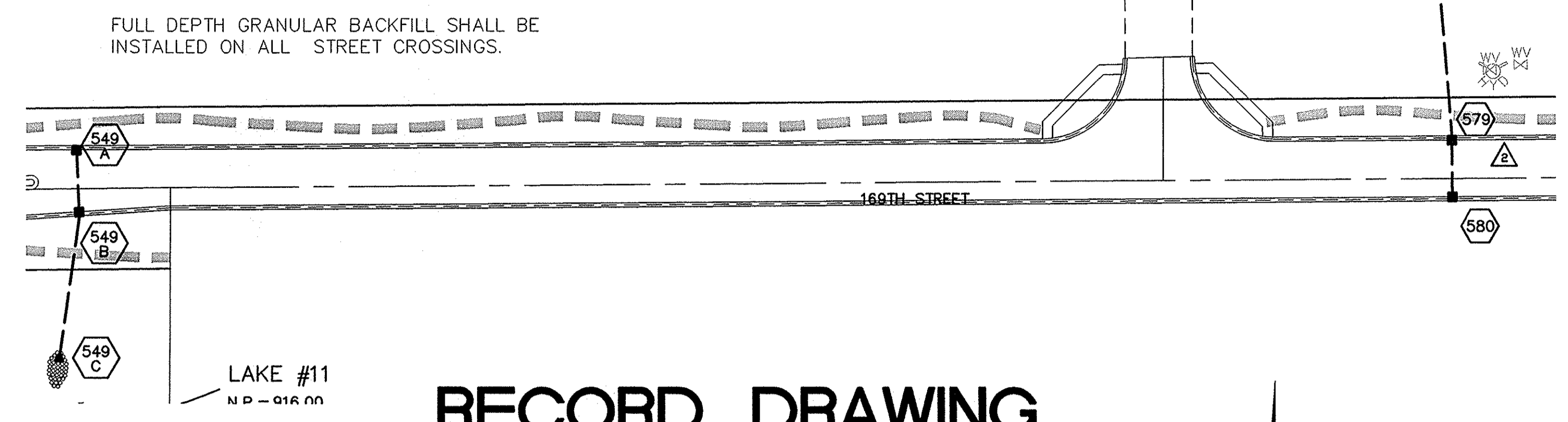

RECORD DRAWING

Jeffery W. Darling
JEFFERY W. DARLING
Registered Land Surveyor
No. 900017
DATE 7/27/06



DATE	BY	REVISIONS
10/2/05	ASB/ATS	
9/22/05	REVISION FOR EXISTING FIELD LOCATION	
7/12/05	REVISION FOR DEVELOPER COMMENTS	
7/1/05	REV. FOR V.P. COMMENTS	
6/22/05	REVISION FOR SURVEYOR'S COMMENT	
4/12/05	REVISION FOR IAC COMMENTS	
2/22/05	REVISION FOR DEVELOPER	
3/16/05	DATE	

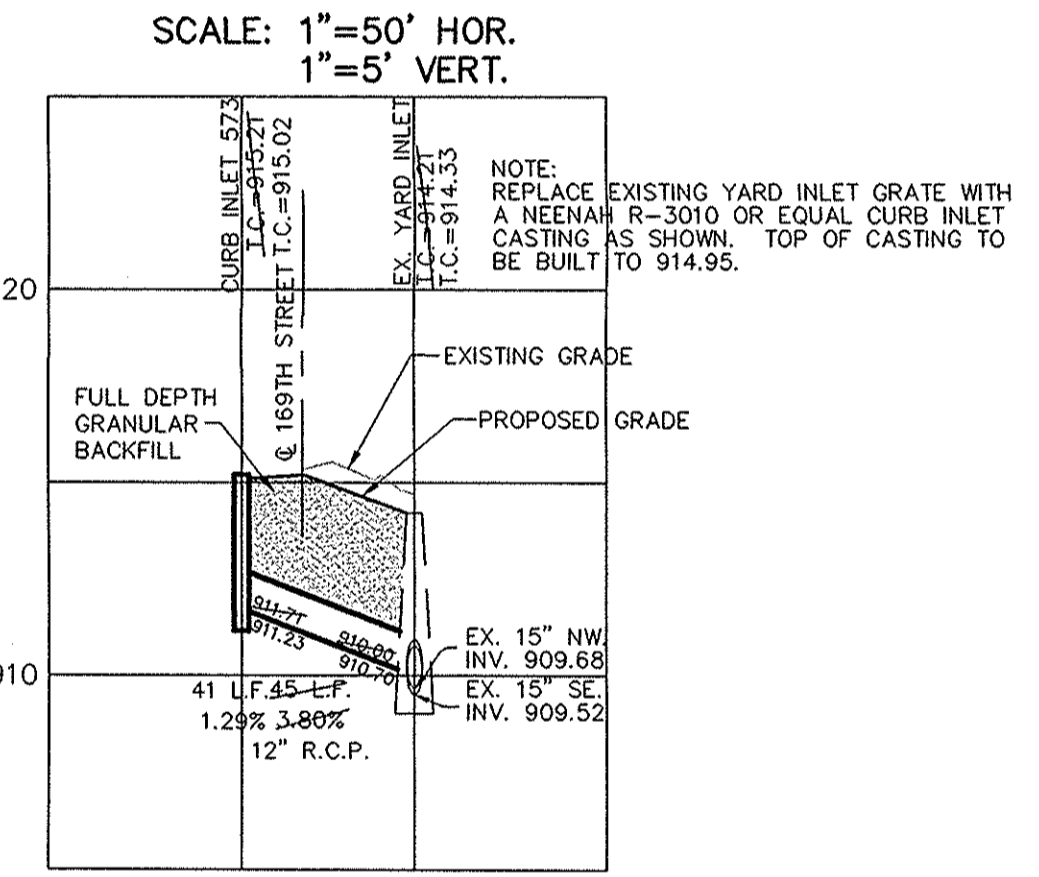
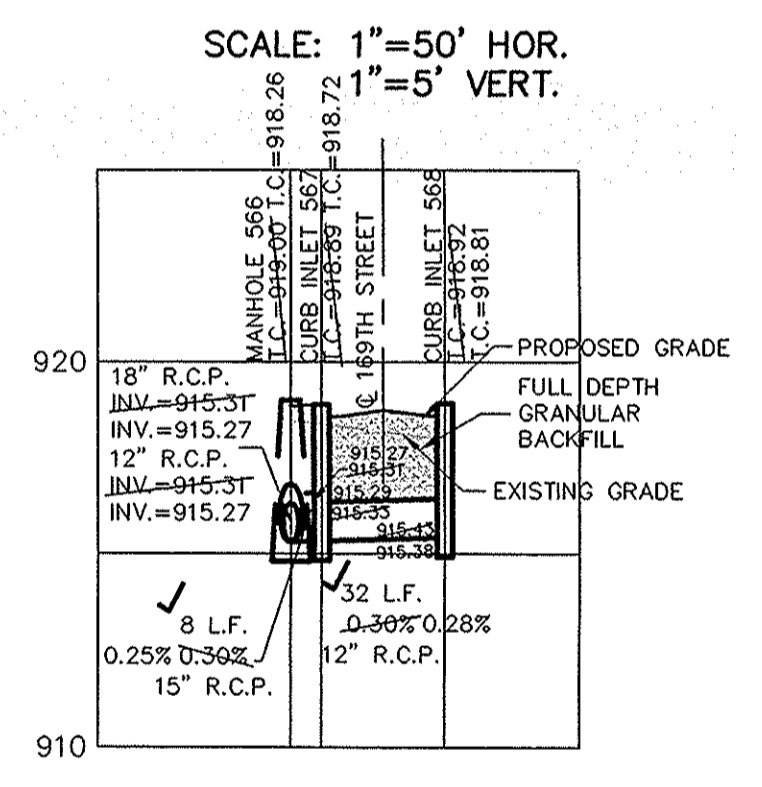
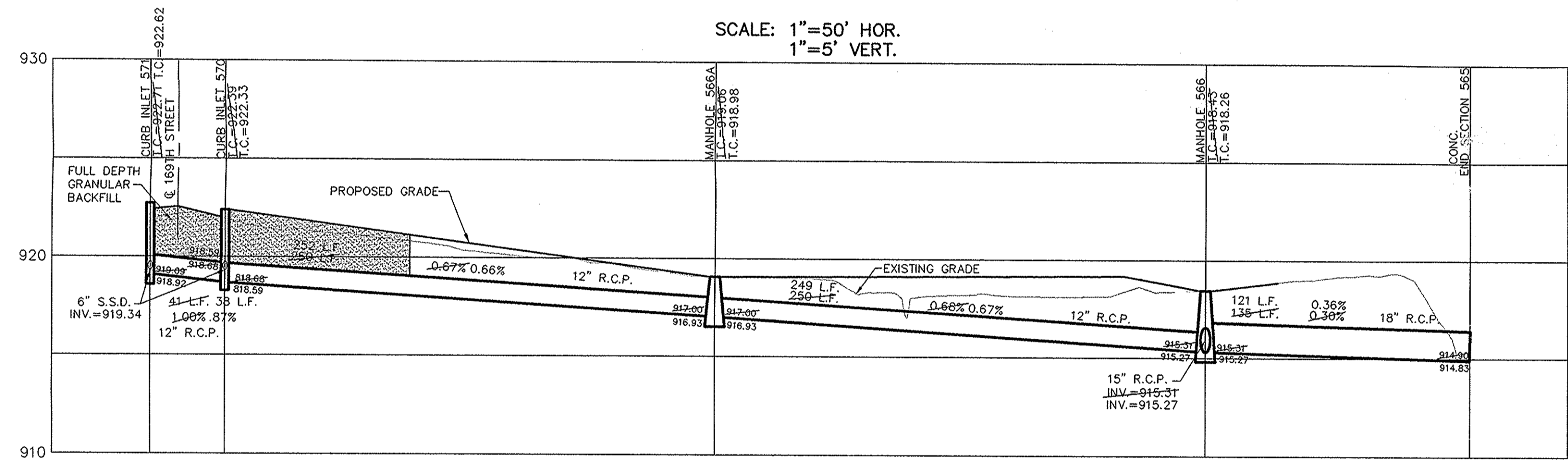

This information was gathered for input into the Hamilton County Geographic Information System (GIS). This document is considered an official record of the GIS.
Entry Date: 3-28-08
Entered By: SLM

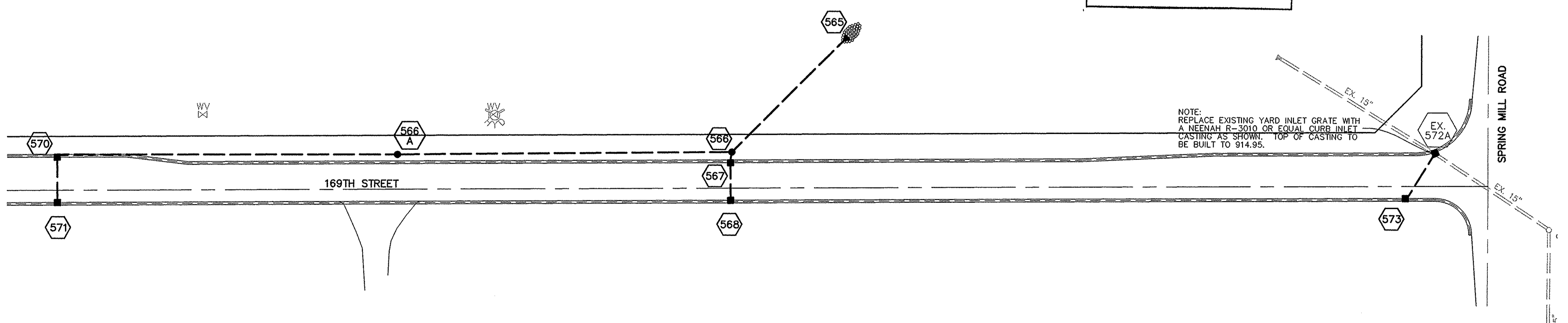

NOTE: ALL STORM STRUCTURES TO RECEIVE SOLID LID CASTINGS ARE TO BE CONSTRUCTED TO PROVIDE 1"-4" RISER RING TO ACHIEVE PLAN RIM GRADE.
ALL YARD INLETS ARE TO BE CONSTRUCTED AT A TOLERANCE OF +0.00' TO 0.20' OF PLAN GRADE.
ALL STORM SEWER CASTINGS SHALL BE LABELED "DUMP NO WASTE-DRAINS TO WATERWAY"

PIPE SIZE	STRUCTURES LESS THAN 48" FROM T/C TO INVERT	STRUCTURES GREATER THAN 48" FROM T/C TO INVERT	ANGLE AND QUALITY OF PIPES WILL REQUIRE SPECIAL DESIGN	STEPS REQUIRED	CURB CASTING *R-3501 N	CASTING *3501 TL & TR
12" to 18"	24"x24"		DESIGN APPROVAL	No	Yes	Yes
12" to 21"	30"x30"		DESIGN APPROVAL	No	Yes	Yes
18" to 21"		MH/BOX	DESIGN APPROVAL	Yes	Yes	Yes
21" to 27"	24"x36"		DESIGN APPROVAL	No	No	Yes
12" to 24"	36"x36"		DESIGN APPROVAL	No	Yes	Yes
24" OR LARGER			DESIGN APPROVAL	No	No	Yes
24" or LARGER		MH/BOX	DESIGN APPROVAL	Yes**	Yes	Yes

* PIPES NO LARGER THAN 18" CAN BE USED IN THE 2' SIDE OF THIS BOX
** INCLUDING AND OUT GOING PIPES EFFECT STEPS IN THIS STRUCTURE
SPECIAL NOTE: STRUCTURES DEEPER THAN 48" FROM T/C TO INVERT WILL BE A M.H. OR A BOX WITH STEPS UNLESS SPECIAL DESIGN IS APPROVED.
SPECIAL NOTE: STRUCTURES WILL BE DESIGNED FOR MAXIMUM FLOW IN PIPES
SPECIAL NOTE: COUNTY MAY REQUIRE STEPS TO BE INSTALLED AFTER STRUCTURE IS SET, TO IMPROVE ACCESS.

CONSULTING ENGINEERS - LAND SURVEYORS
(317) 849-5935 1-800-728-6917 FAX: (317) 849-5942
FISHERS INDIANA
WESTFIELD INDIANA
STORM PLAN & PROFILES
169TH STREET RECONSTRUCTION

SCALE: 1"=50' HOR.
1"=5' VERT.

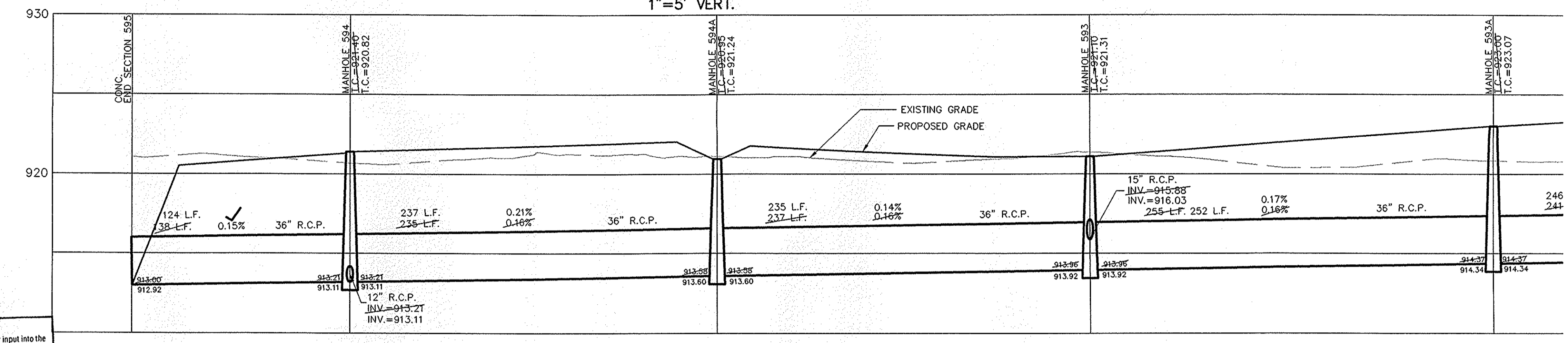

SCALE: 1"= 50'



Information was gathered for input into the Hamilton County Geographic Information System (GIS). This document is considered an official record of the GIS.
Entry Date: 3-28-08
Entered By: SLK

SCALE: 1"=50' HOR.
1"=5' VERT.

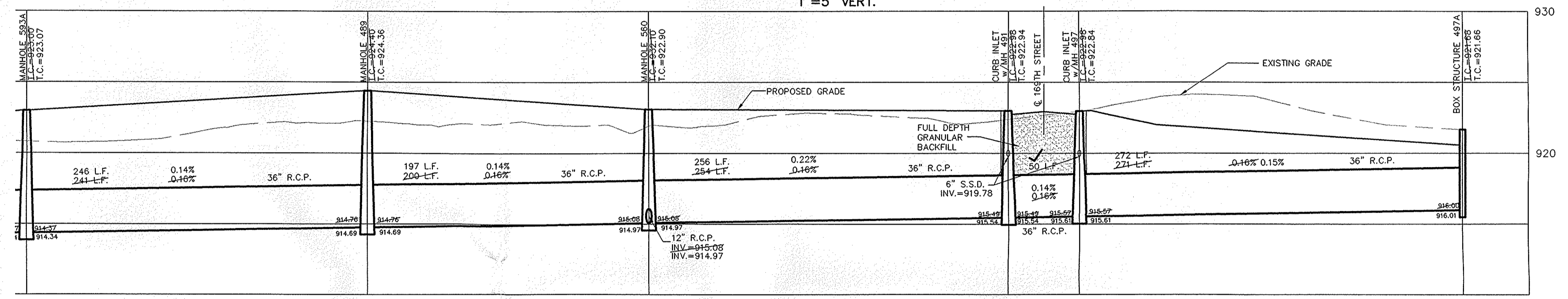

SCALE: 1"=50' HOR.
1"=5' VERT.

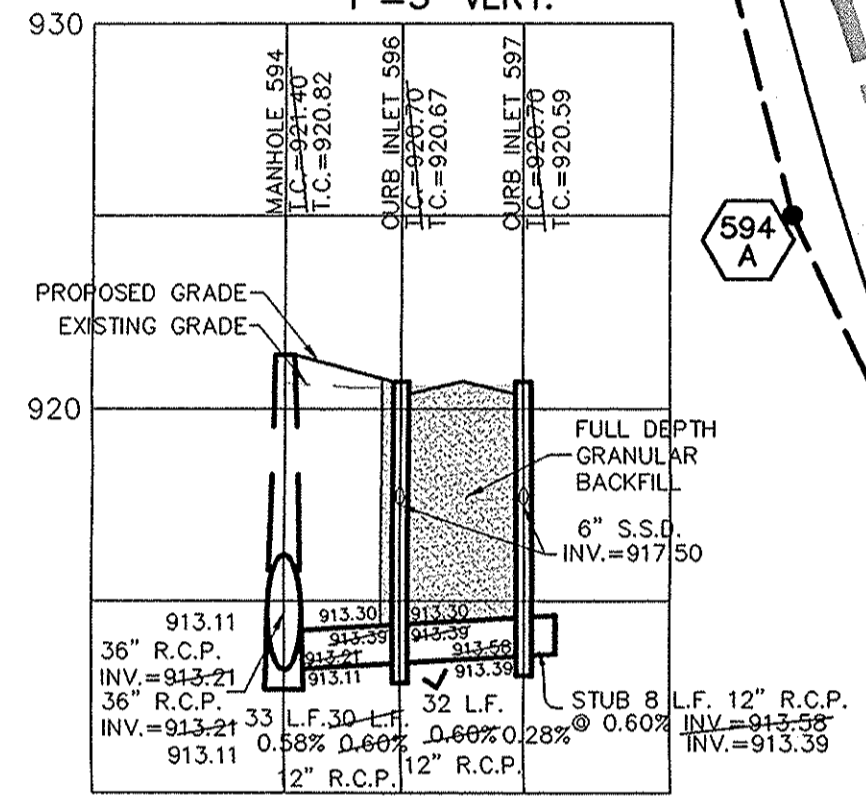

SCALE: 1"=50' HOR.
1"=5' VERT.

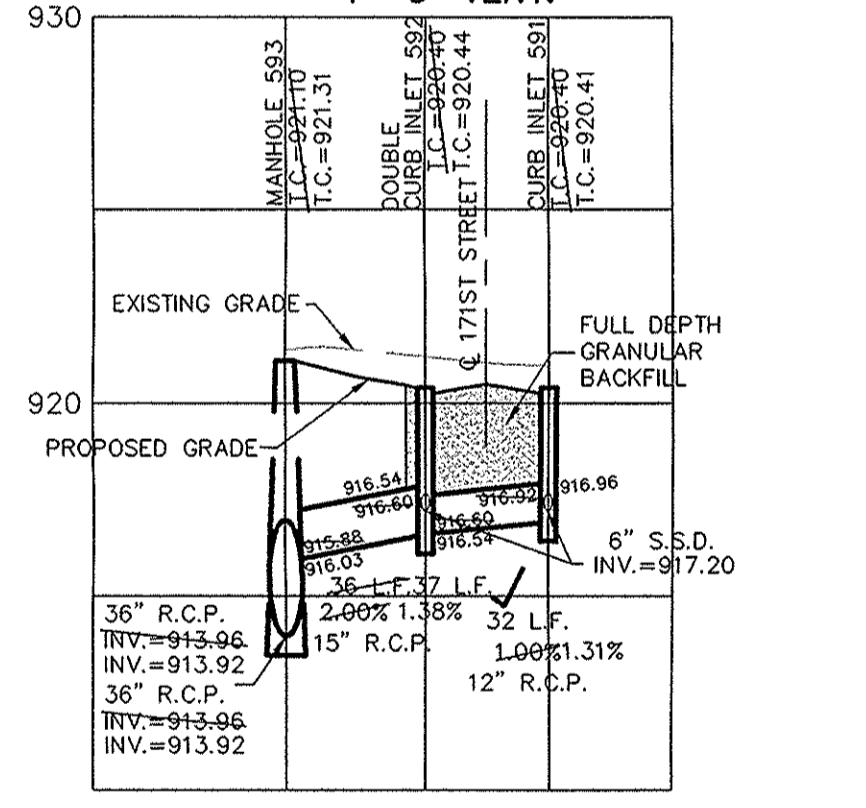

CURB INLET TABLE

PIPE SIZE	STRUCTURES LESS THAN 48" FROM T/C TO INVERT	STRUCTURES GREATER THAN 48" FROM T/C TO INVERT	ANGLE AND QUALITY OF PIPES WILL REQUIRE SPECIAL DESIGN	STEPS REQUIRED	CURB CASTING *R-3501 N	CASTING *3501 TL & TR
12" to 18"	24"x24"		DESIGN APPROVAL	No	Yes	Yes
12" to 21"	30"x30"		DESIGN APPROVAL	No	Yes	Yes
18" to 21"		MH/BOX	DESIGN APPROVAL	Yes	Yes	Yes
21" to 27"	24"x36"		DESIGN APPROVAL	No	No	Yes
12" to 24"	36"x36"		DESIGN APPROVAL	No	Yes	Yes
24" OR LARGER	DESIGN APPROVAL		DESIGN APPROVAL	No	No	Yes
24" OR LARGER		MH/BOX	DESIGN APPROVAL	Yes**	Yes	Yes

* PIPES NO LARGER THAN 18" CAN BE USED IN THE 2' SIDE OF THIS BOX
** INCOMING AND OUT GOING PIPES EFFECT STEPS IN THIS STRUCTURE
SPECIAL NOTE: STRUCTURES DEEPER THAN 48" FROM T/C TO INVERT WILL BE A MH OR A BOX WITH STEPS UNLESS SPECIAL DESIGN IS APPROVED.
SPECIAL NOTE: STRUCTURES WILL BE DESIGNED FOR MAXIMUM FLOW IN PIPES
SPECIAL NOTE: COUNTY MAY REQUIRE STEPS TO BE INSTALLED AFTER STRUCTURE IS SET, TO IMPROVE ACCESS.

SCALE: 1"=50' HOR.
1"=5' VERT.

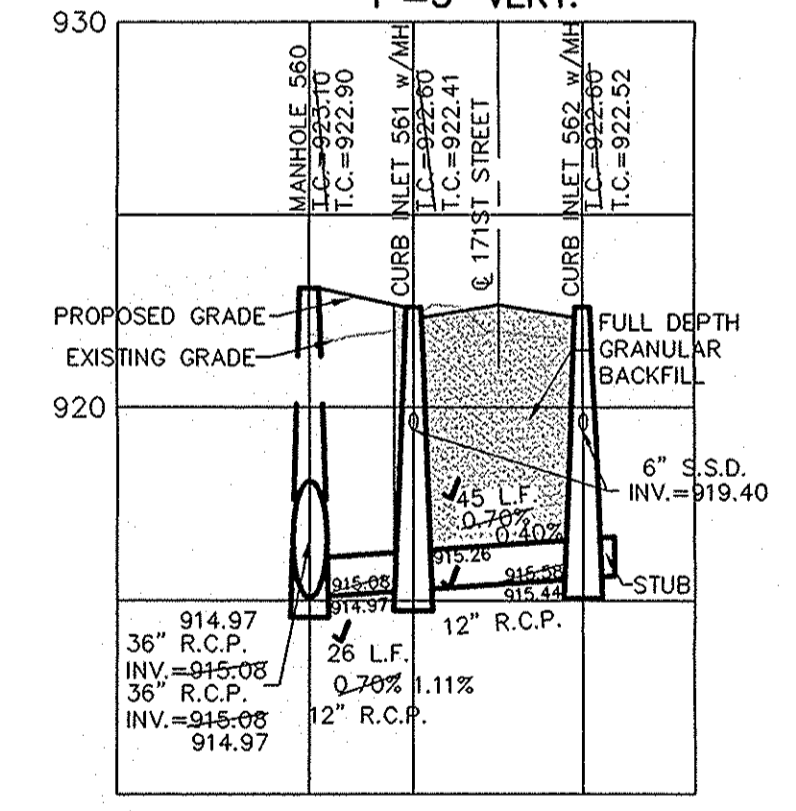

SCALE: 1"=50' HOR.
1"=5' VERT.

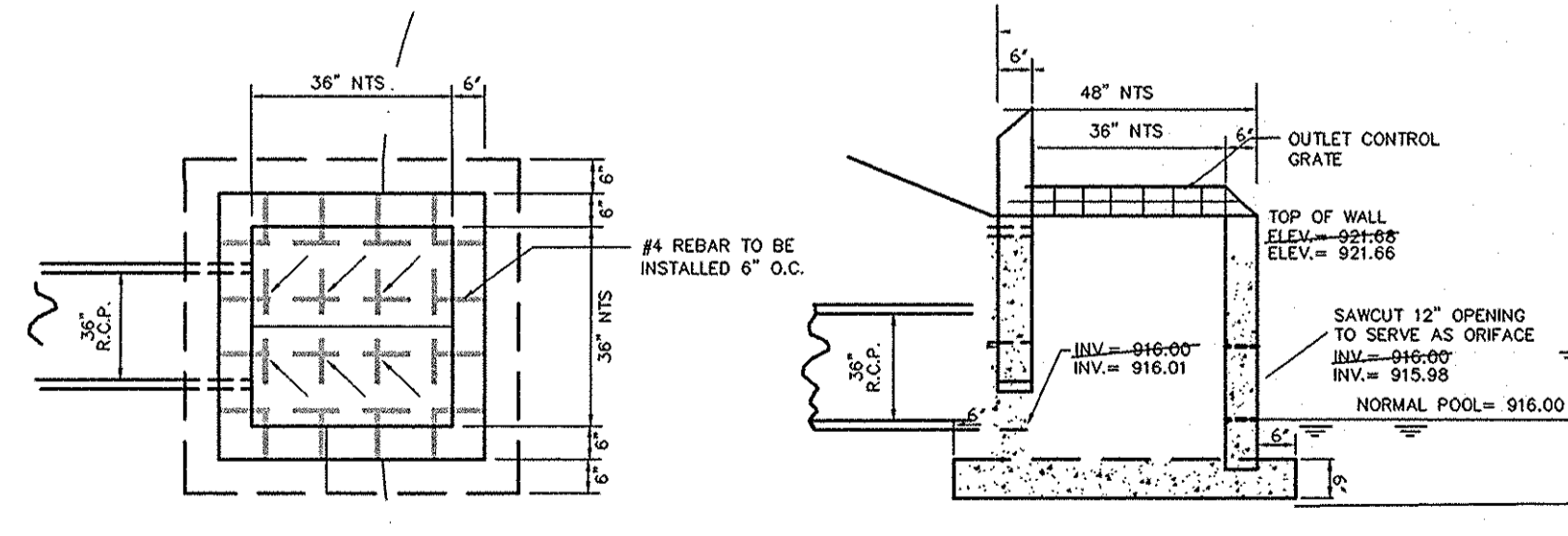
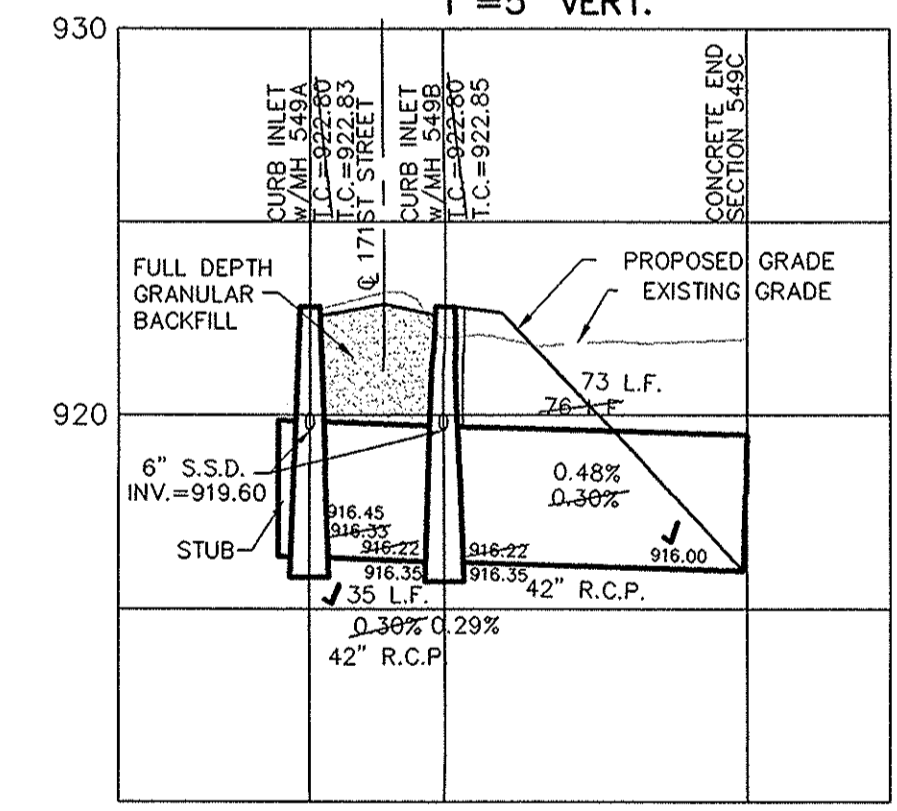

SPECIAL STRUCTURE NO. 497A DETAIL
NOT TO SCALE

NOTE: ALL STORM STRUCTURES TO RECEIVE SOLID LID CASTINGS ARE TO BE CONSTRUCTED TO PROVIDE 1'-4" RISER RING TO ACHIEVE PLAN RIM GRADE.
ALL YARD INLETS ARE TO BE CONSTRUCTED AT A TOLERANCE OF +0.00' TO 0.20' OF PLAN GRADE.
ALL STORM SEWER CASTINGS SHALL BE LABELED "DUMP NO WASTE-DRAINS TO SHALLOWWAY"

NOTES: 1. DECORATIVE SIGNS, SPRINKLER SYSTEMS, TREES, LANDSCAPING MOUNDS, LIGHT POLES, OR OTHER SUCH AMENITIES ARE NOT PERMITTED IN THE RIGHT OF WAY.
2. ALL CURB IS 6" CHAIR BACK CURB, UNLESS OTHERWISE NOTED.

RECORD DRAWING

JEFFORY W. DARLING
JEFFORY W. DARLING
Registered Land Surveyor
No. 900017
DATE 7/27/06

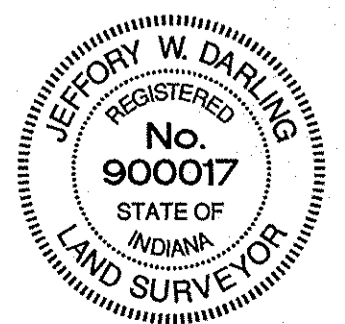

CONSULTING ENGINEERS - LAND SURVEYORS
(317) 849-5935 1-800-728-6917 FAX (317) 849-5942
WESTFIELD INDIANA

STORM PLAN & PROFILES
169TH STREET RECONSTRUCTION
WESTFIELD INDIANA

SHEET NO. C601
JOB NO. 34676STR

CERTIFIED: 3/16/05
DAVID J. STAPP
REGISTERED PROFESSIONAL ENGINEER
STATE OF INDIANA
NO. 19338

DATE	REVISIONS
7/14/06	ASBUILT
7/14/06	REVISED PER DEVELOPER COMMENTS
7/17/05	REV. PER W/P COMMENTS
6/02/05	REVISED PER SURVIVORS COMMENT
4/11/05	REVISED PER TAC COMMENTS
2/28/05	REVISED PER DEVELOPER

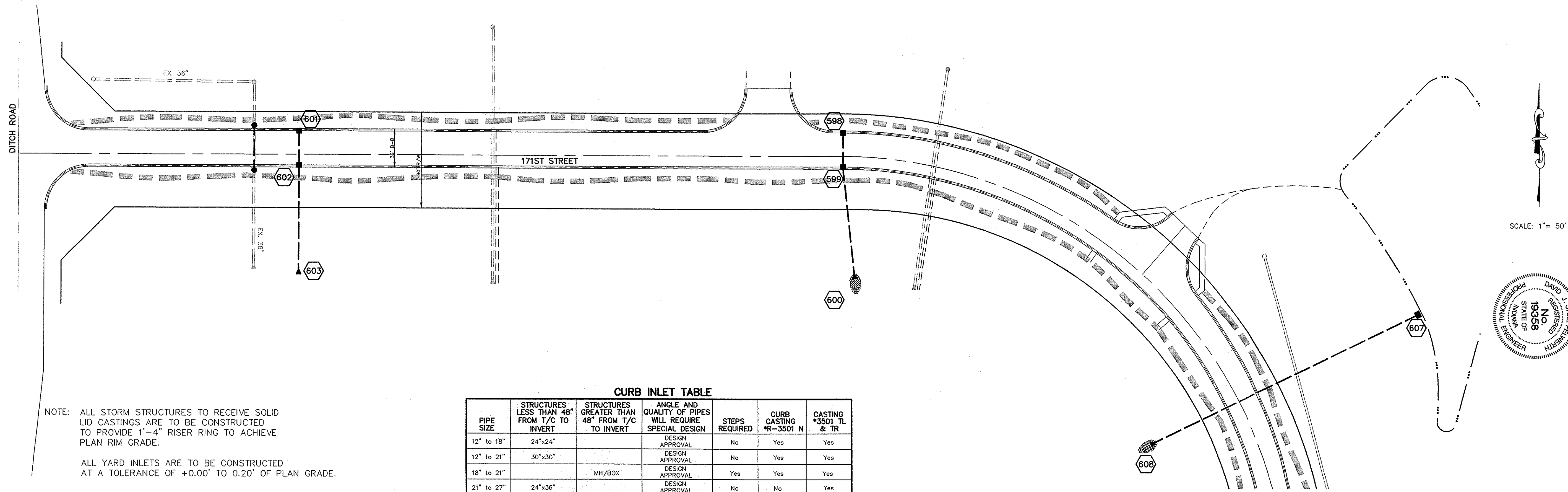

NOTE: ALL STORM STRUCTURES TO RECEIVE SOLID LID CASTINGS ARE TO BE CONSTRUCTED TO PROVIDE 1'-4" RISER RING TO ACHIEVE PLAN RIM GRADE.

ALL YARD INLETS ARE TO BE CONSTRUCTED AT A TOLERANCE OF +0.00' TO 0.20' OF PLAN GRADE.

ALL STORM SEWER CASTINGS SHALL BE LABELED "DUMP NO WASTE-DRAINS TO WATERWAY"

NOTE: DECORATIVE SIGNS, SPRINKLER SYSTEMS, TREES, LANDSCAPING MOUNDS, LIGHT POLES, OR OTHER SUCH AMENITIES ARE NOT PERMITTED IN THE RIGHT OF WAY.

FULL DEPTH GRANULAR BACKFILL SHALL BE INSTALLED ON ALL STREET CROSSINGS.

PIPE SIZE	STRUCTURES LESS THAN 48" FROM T/C TO INVERT	STRUCTURES GREATER THAN 48" FROM T/C TO INVERT	ANGLE AND QUALITY OF PIPES WILL REQUIRE SPECIAL DESIGN	STEPS REQUIRED	CURB CASTING *R-3501 N	CASTING *3501 TL & TR
12" to 18"	24"x24"		DESIGN APPROVAL	No	Yes	Yes
12" to 21"	30"x30"		DESIGN APPROVAL	No	Yes	Yes
18" to 21"		MH/BOX	DESIGN APPROVAL	Yes	Yes	Yes
21" to 27"	24"x36"		DESIGN APPROVAL	No	No	Yes
12" to 24"	36"x36"		DESIGN APPROVAL	No	Yes	Yes
24" OR LARGER	DESIGN APPROVAL		DESIGN APPROVAL	No	No	Yes
24" OR LARGER	MH/BOX		DESIGN APPROVAL	Yes**	Yes	Yes

* PIPES NO LARGER THAN 18" CAN BE USED IN THE 2' SIDE OF THIS BOX

** INCOMING AND OUT GOING PIPES EFFECT STEPS IN THIS STRUCTURE

SPECIAL NOTE: STRUCTURES DEEPER THAN 48" FROM T/C TO INVERT WILL BE A MH OR A BOX WITH STEPS UNLESS SPECIAL DESIGN IS APPROVED.

SPECIAL NOTE: STRUCTURES WILL BE DESIGNED FOR MAXIMUM FLOW IN PIPES

SPECIAL NOTE: COUNTY MAY REQUIRE STEPS TO BE INSTALLED AFTER STRUCTURE IS SET, TO IMPROVE ACCESS.

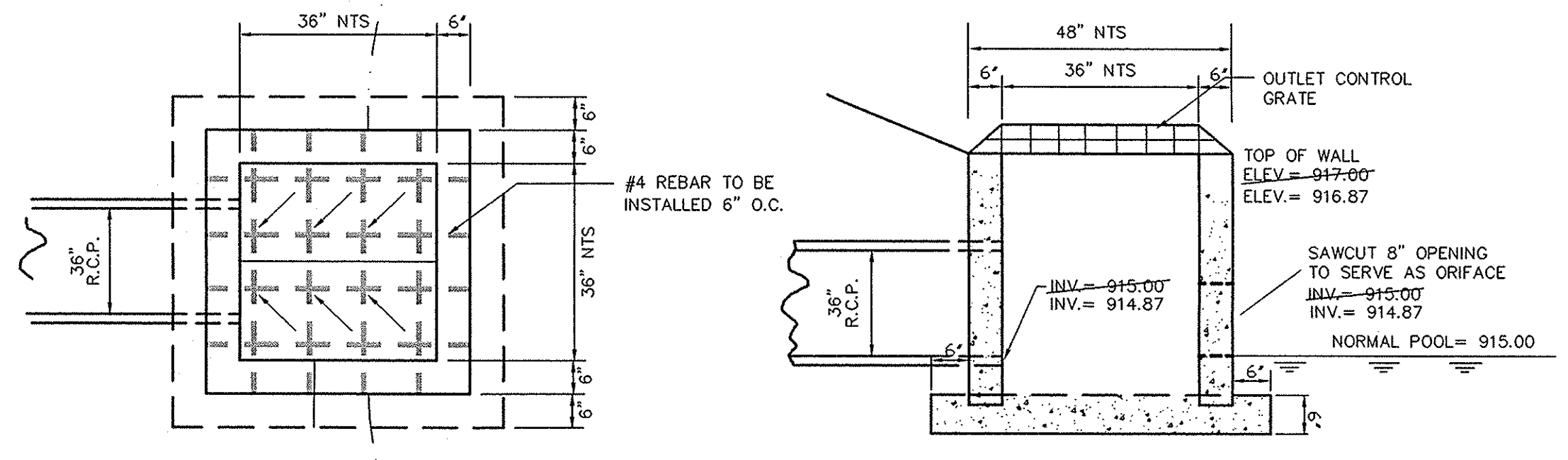
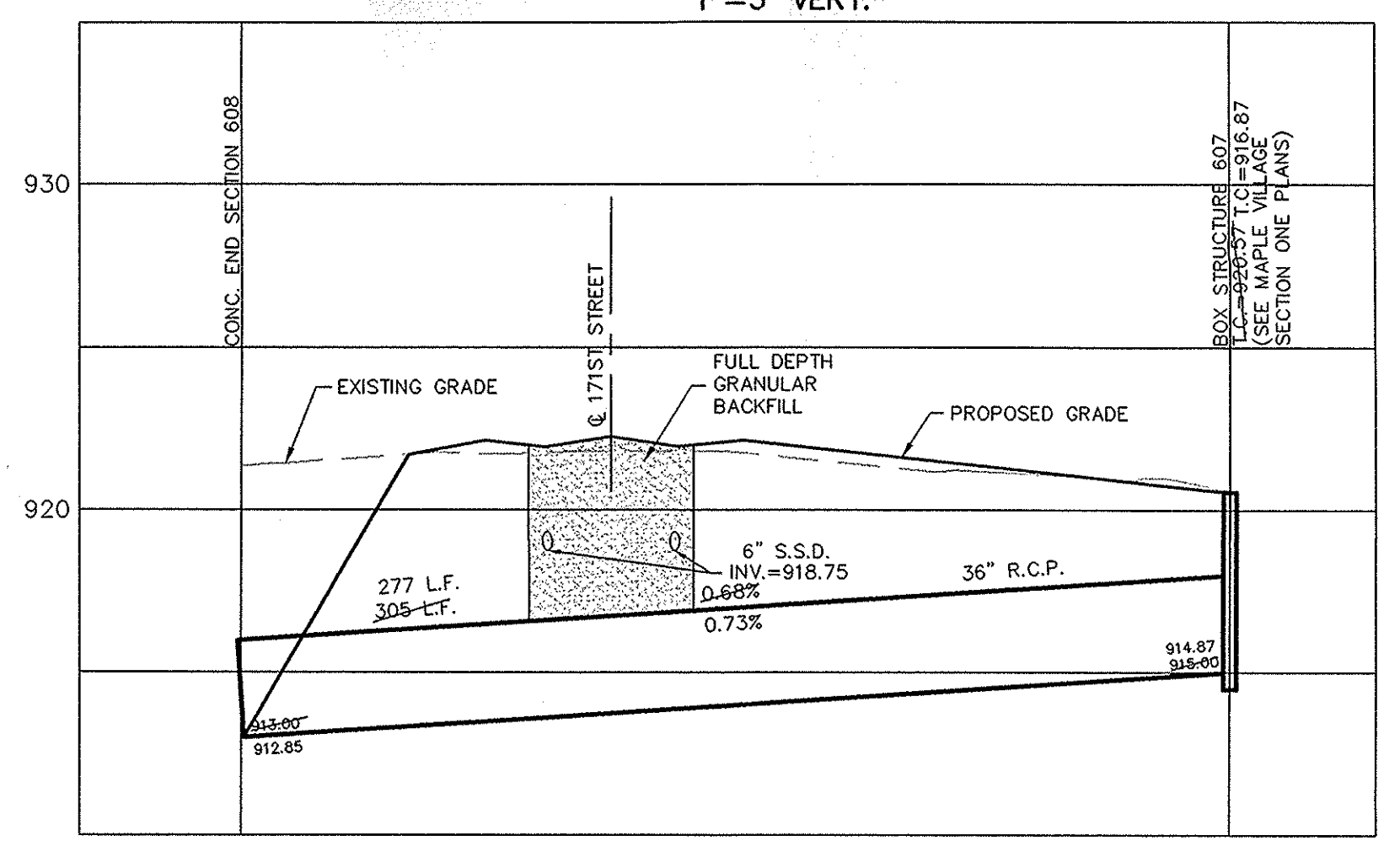
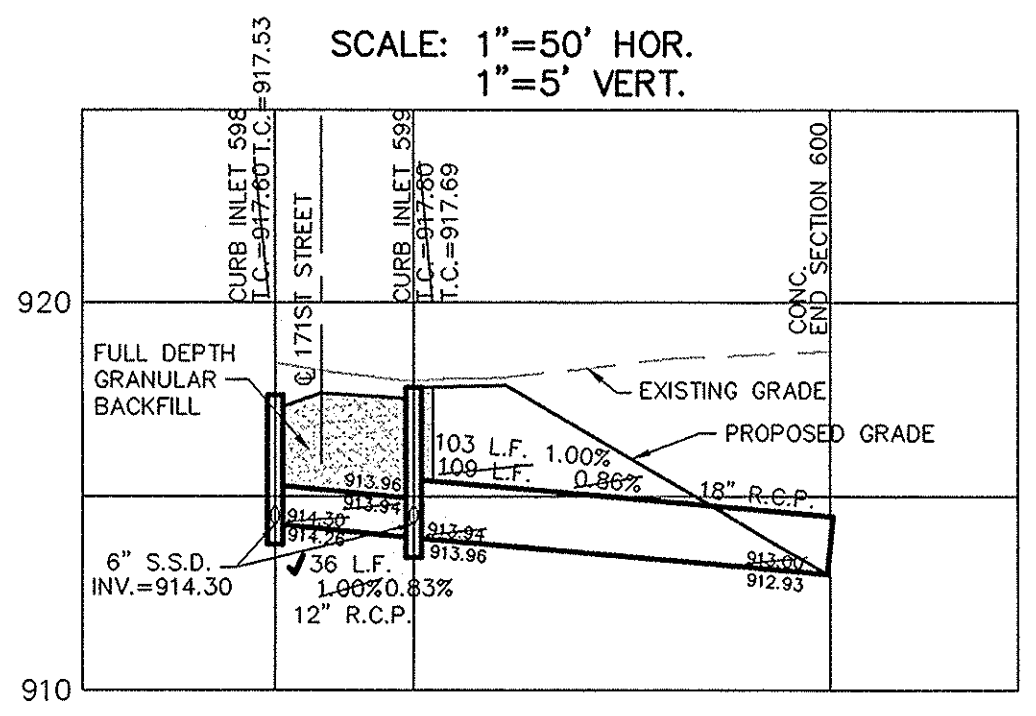
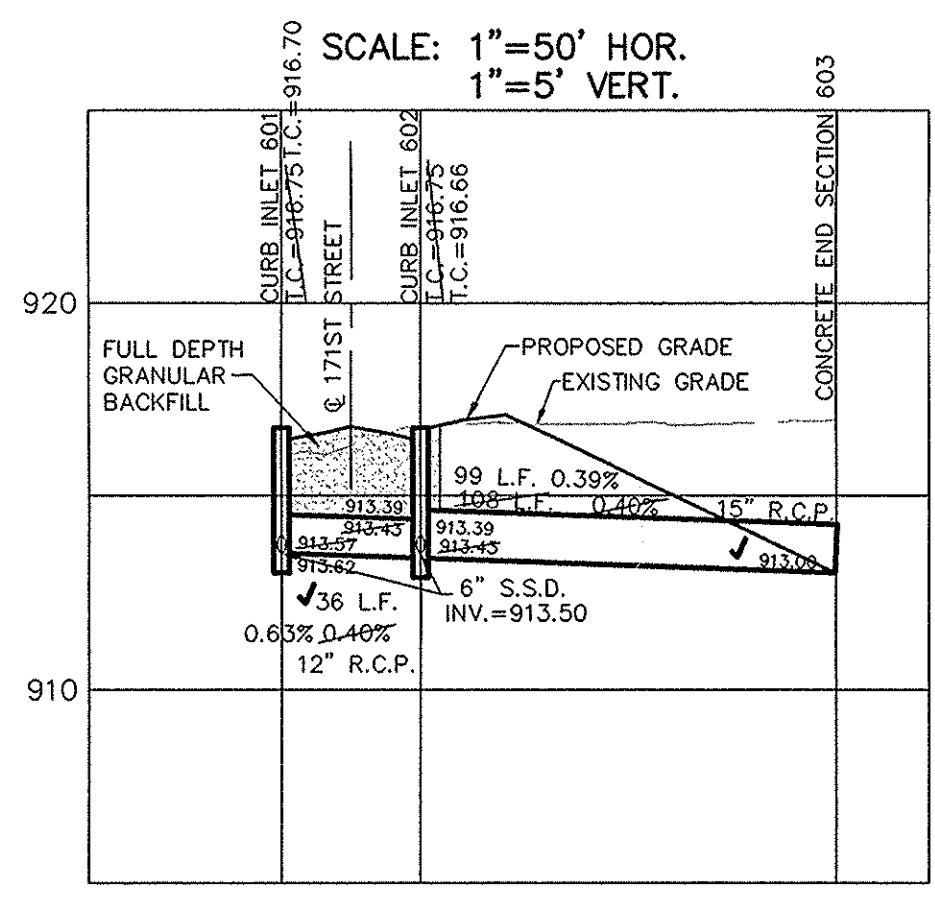

NOTE: CONTRACTOR SHALL VERIFY PROPER METHOD OF ATTACHING TO OUTLET STRUCTURE PRIOR TO FABRICATION & INSTALLATION

SPECIAL STRUCTURE NO. 504 DETAIL
NOT TO SCALE

RECORD DRAWING

Jeffery W. Darling
JEFFERY W. DARLING
Registered Land Surveyor
No. 900017

7/27/06
DATE



Information was gathered for input into the Hamilton County Geographic Information System (GIS). This document is considered an official record of the GIS.

Entry Date: 3-28-08
Entered By: SLM

ASSEMBLER	7-14-05	DATE	MARK	REVISIONS	BY
REVIEWED PER DEVELOPER COMMENTS	7/25/05	DWG. BY	JDH		
REVIEWED PER DEVELOPER COMMENTS	7/27/05	CHK. BY	EEF		
REVIEWED PER DEVELOPER COMMENTS	7/27/05	SCALE	1"=50'		
REVIEWED PER DEVELOPER COMMENTS	6/02/05	DATE	3/16/05		
REVIEWED PER DEVELOPER COMMENTS	4/17/05				
REVIEWED PER DEVELOPER COMMENTS	2/28/05				

CERTIFIED: 3/16/05

David J. Stapp
CONSULTING ENGINEERS - LAND SURVEYORS
INDIANA
(317) 849-5935 1-800-728-6917 FAX: (317) 849-5942

STORM PLAN & PROFILES
169TH STREET RECONSTRUCTION
WESTFIELD, INDIANA

SHEET NO.
C600
JOB NO 34676STR

SCALE: 1"=50' HOR.
1"=5' VERT.

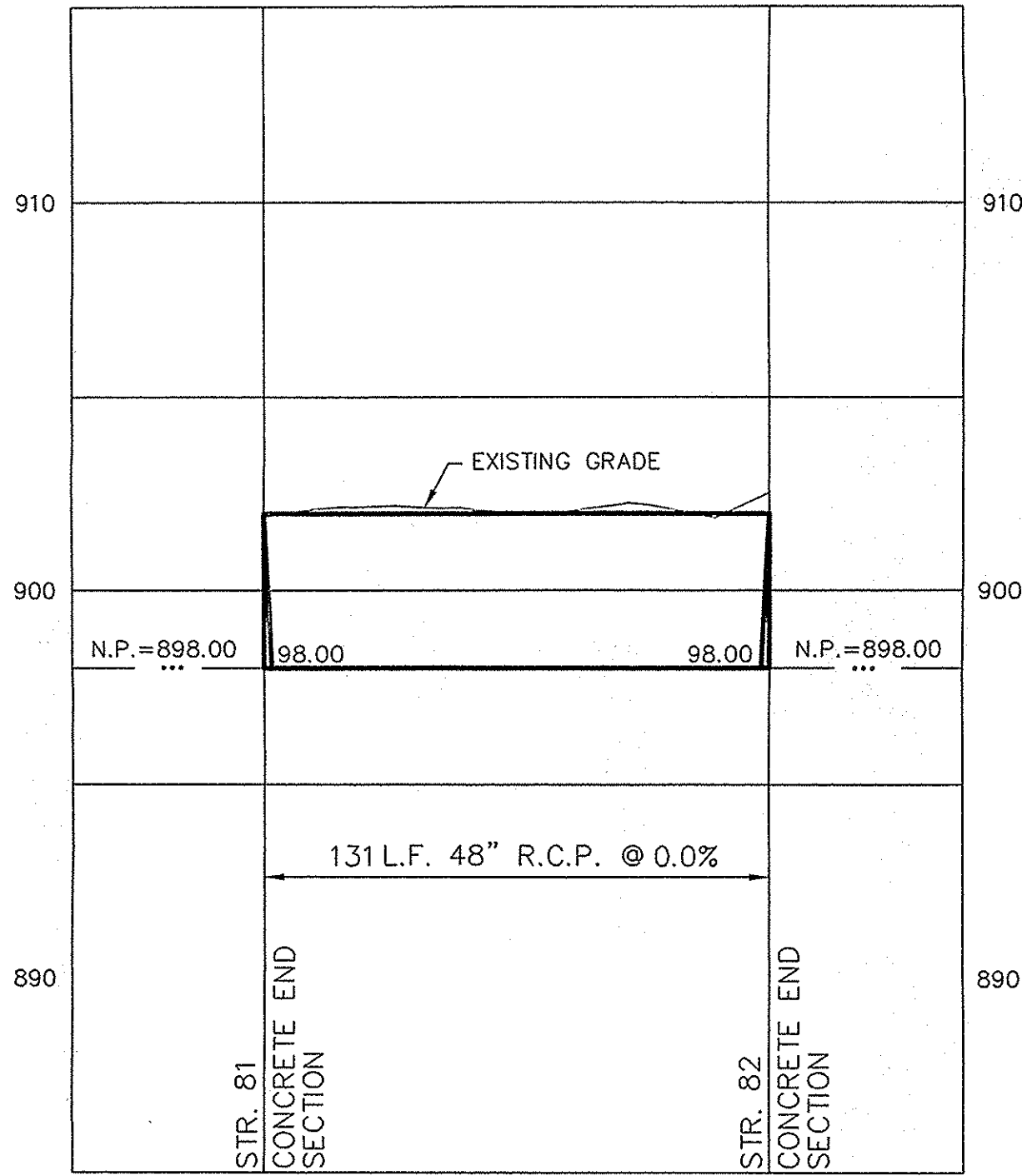

STORM 7

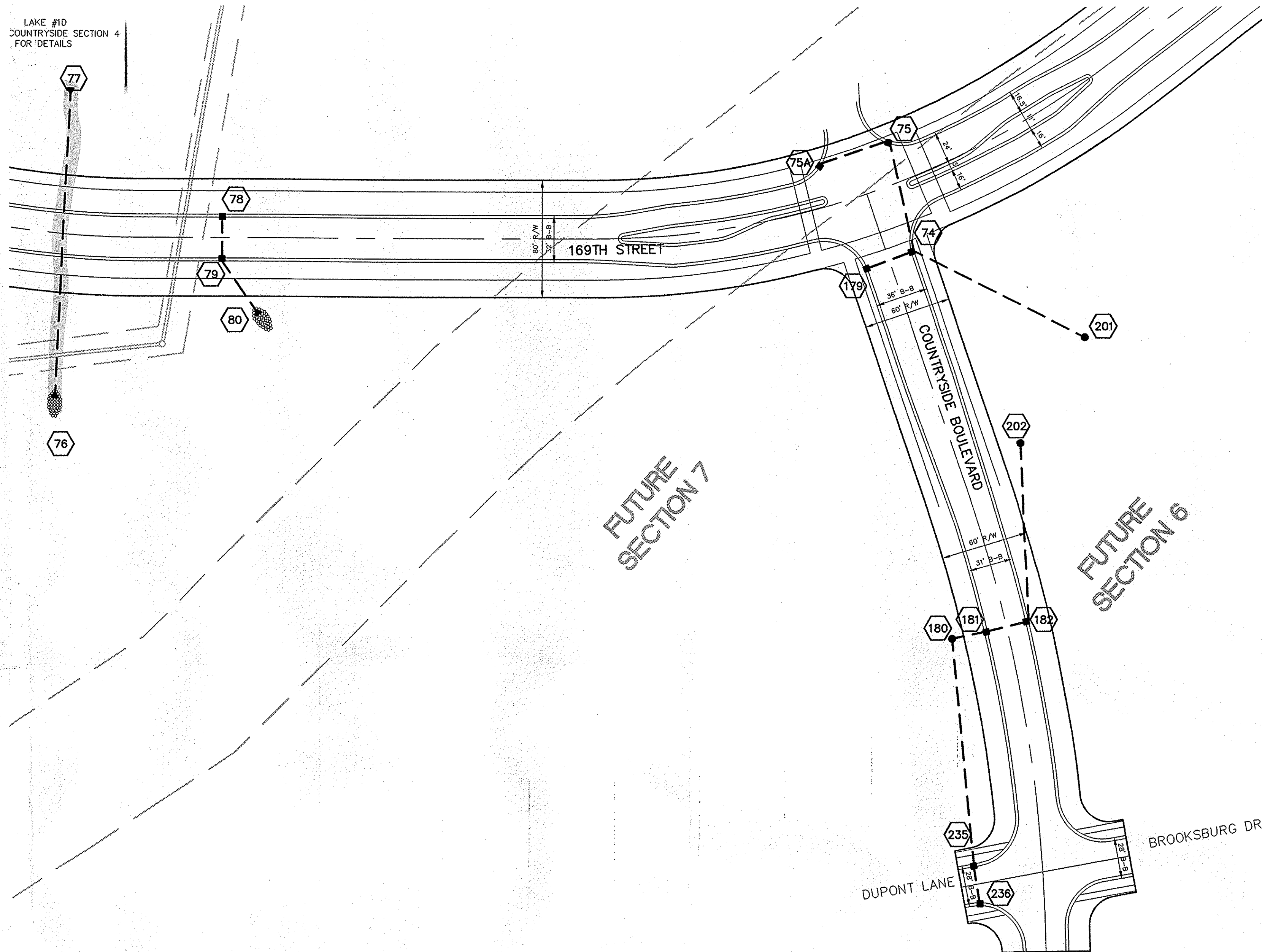

SCALE: 1"=50'

DAVID J. STOEPELWERT
REGISTERED
No. 19358
STATE OF INDIANA
PROFESSIONAL ENGINEER

RECORD DRAWING

Jeffery W. Darling
JEFFERY W. DARLING
Registered Land Surveyor
No. 900017

11/16/99 DATE

This information was gathered for input into the Hamilton County Geographic Information System (GIS). This document is considered an official record of the GIS.

Entry Date: 3-18-09
Entered By: SLM

SCALE: 1"=50' HOR.
1"=5' VERT.

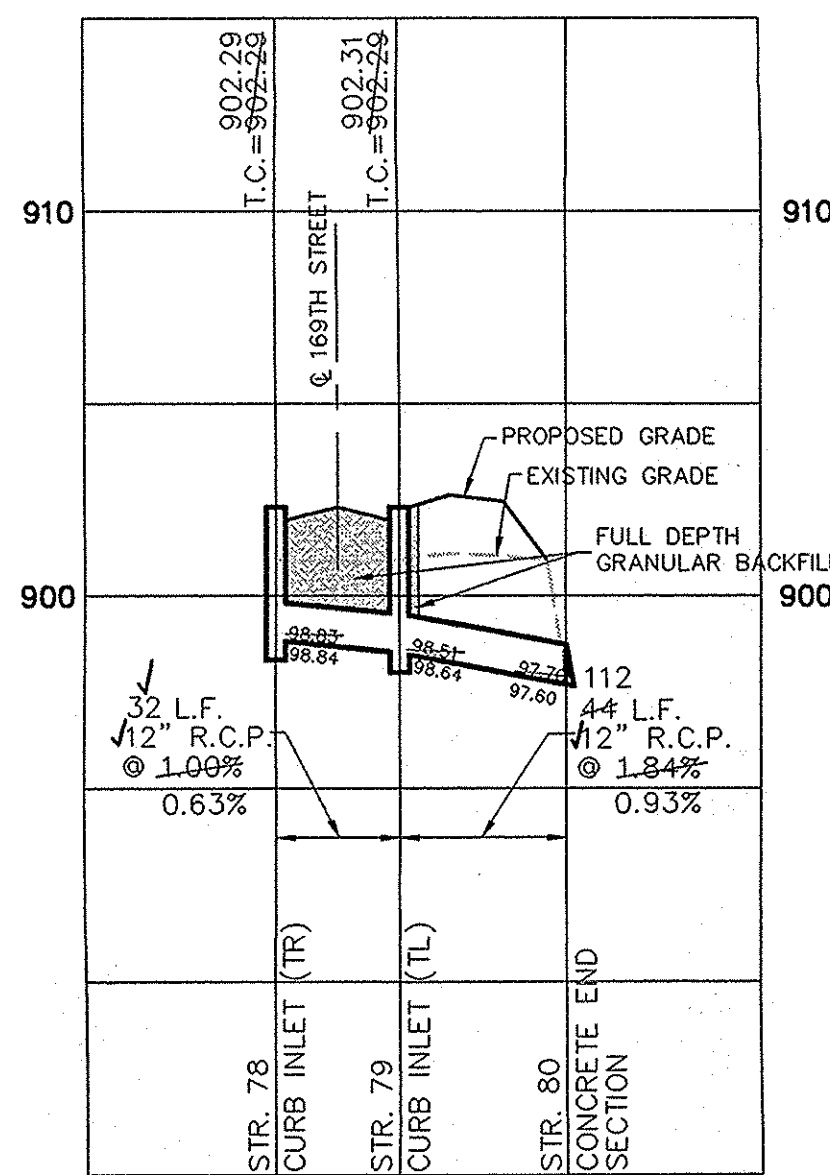

SCALE: 1"=50' HOR.
1"=5' VERT.

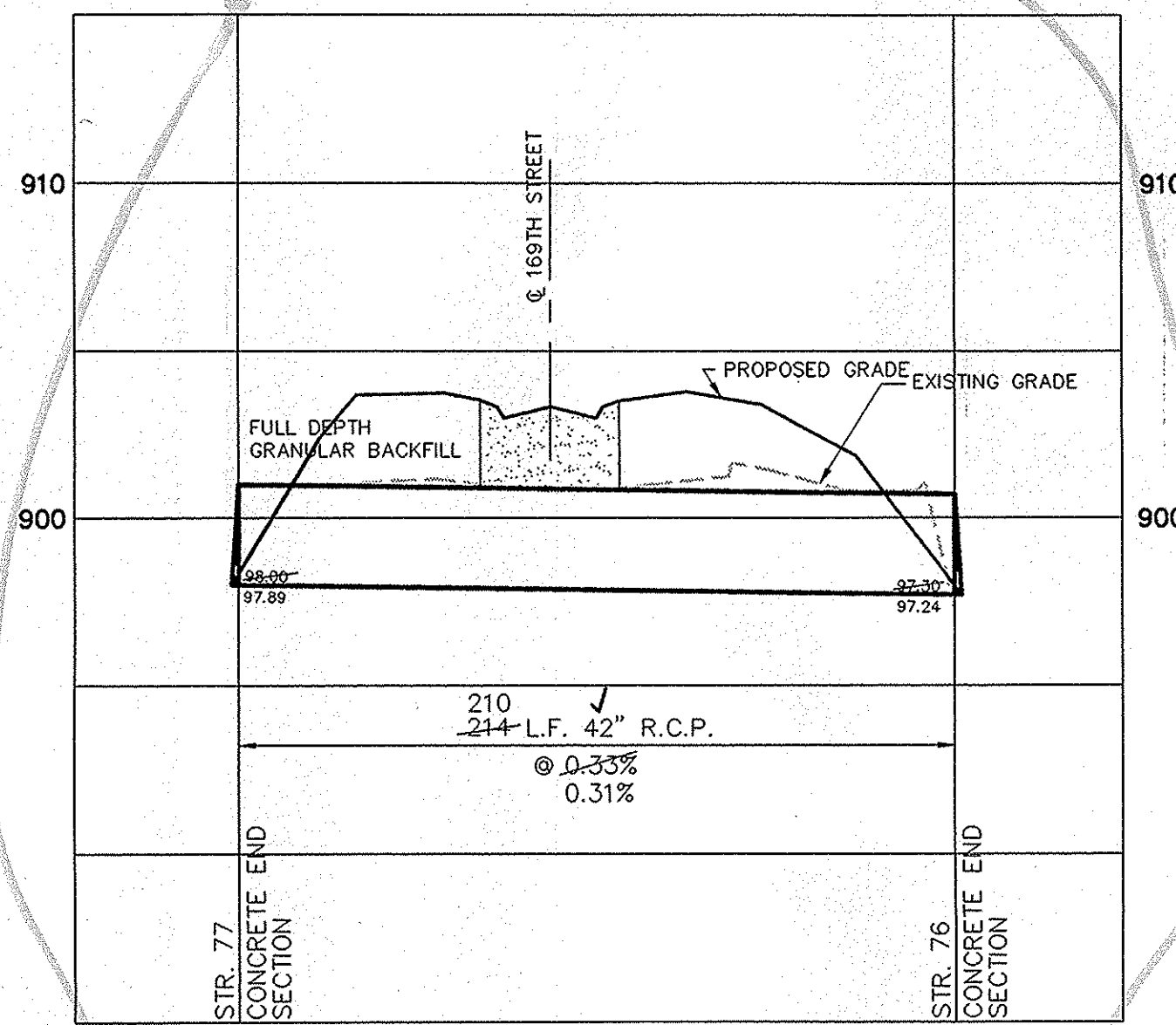

SCALE: 1"=50' HOR.
1"=5' VERT.

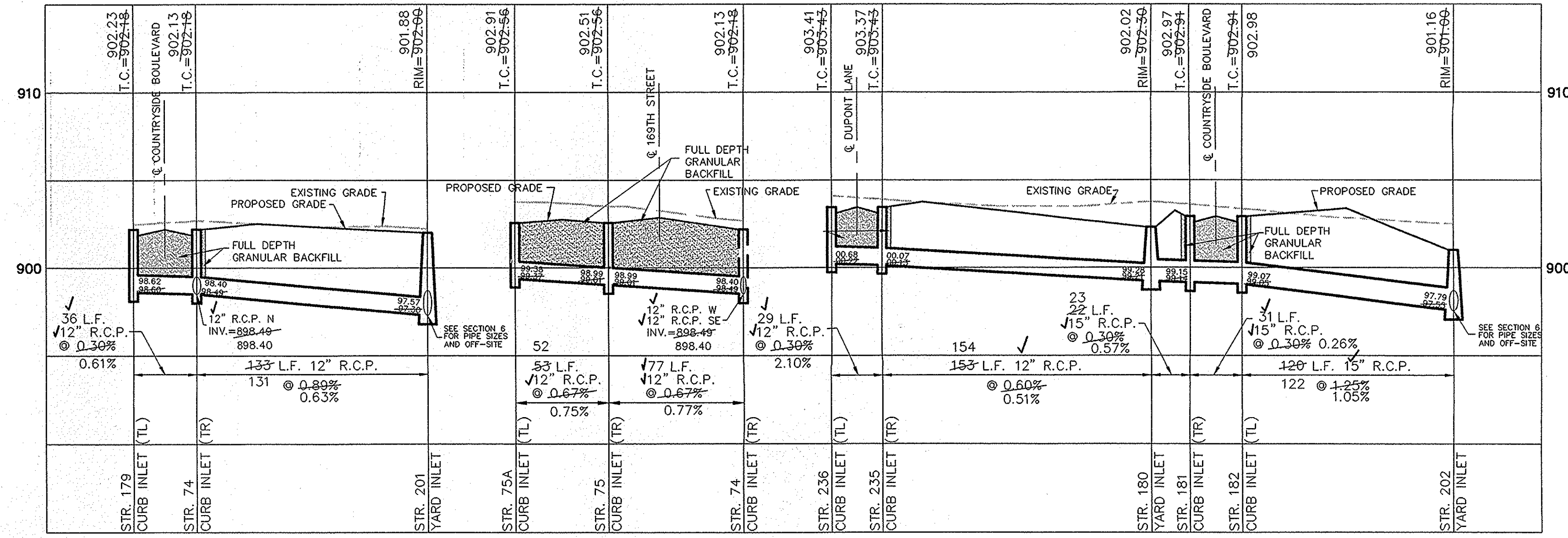

DATE: 1/20/99
DRAWN BY: TSM
CHECKED BY: EEF
SCALE: 1"=50'
DATE: 1/20/99

CERTIFIED: 1/20/99
David J. Stoppelwert

CONSULTING ENGINEERS - LAND SURVEYORS
(317) 849-5935 1-800-728-6917 FAX: (317) 849-5942
INDIANAPOLIS, INDIANA

INDIANAPOLIS, INDIANA

STORM SEWER PLAN & PROFILE
169TH STREET REALIGNMENT

INDIANAPOLIS, INDIANA

FILED
FEB 11 2004
OFFICE OF HAMILTON COUNTY SUPERVISOR

SHEET NO. 13
of 19 SHEETS
JOB NO. 29730

S:\279305TR(dwg)\Stm-3.dwg, Layout1, 12/1/2003 8:15:46 AM, zmaggard, 1:41.5086